



**Menlo Park Fire Protection District
Fire Prevention Bureau**

170 Middlefield Rd

Menlo Park, CA 94025

Phone: (650) 688-8425 Fax: (650) 473-9847

www.menlofire.org

**MENLO PARK FIRE PROTECTION DISTRICT STANDARD
DESIGNATION AND MARKING OF FIRE LANES**

This Standard has been developed pursuant to Article 5 and Appendix D of the California Fire Code as adopted by the Menlo Park Fire Protection District. This Standard provide requirements for the installation and placement of signs and markings designating "fire lanes" when required by the Menlo Park Fire Protection District to provide adequate fire apparatus access. Sign requirements include fire lanes and access roads on both private residential developments and private commercial and industrial properties. Also included in this Standard are requirements for painting curbs and designated areas without curbing.

**FIRE LANE SIGNS
FIRE LANES AND ACCESS ROADS ON
PRIVATE RESIDENTIAL DEVELOPMENTS**

OPTION #1 – "NO PARKING" Signs

Sign "A" Requirements:

Signs marking fire lanes are to be spaced so they can be easily read from one sign to another, but at no time more than 100 feet apart.

Signs are to face on-coming vehicular traffic.

All curbs and adjoining fire lanes or posted areas must be painted red.

All curbs and signs are to be maintained by the property owner

All areas posted under Option #1 are to used sign "A"

All signs must conform to Menlo Park Fire Protection District Standards.

(See Drawing No. 1)

OPTION #2 – "ENTRANCE" Signs

Sign "B" Requirements:

One (1) sign is required at all points of entry to properties with marked parking stalls.

Signs are to face on-coming vehicular traffic

All curbs adjoining fire lanes or posted areas are required to be painted red.

All curbs and signs are to be maintained by the property owner.

All signs must conform to Menlo Park Fire Protection District Standards

**FIRE LANE SIGNS
FIRE LANE AND ACCESS ROADS ON
PRIVAE COMMERCIAL AND INDUSTRIAL PROPERTY**

OPTION #1 – “NO PARKING” Signs

Sign “A” Requirements:

Signs are required within three (3) feet of each end of curbed area and spaced a maximum of fifty (50) feet apart thereafter.

In addition, one (1) sign is required for each island adjacent to a fire lane or access road if the road width is less than 26 feet.

Signs are to face on-coming vehicular traffic.

All curbs and signs are to be maintained by the property owner.

All signs must conform to Menlo Park Fire Protection District Standards.

(See Drawing No. 3)

OPTION #2 – “ENTRANCE “ Signs

One (1) sign is required at all points of entry to properties with marked parking stalls.

Signs are to face on-coming vehicular traffic

All curbs adjoining fire lanes or posted areas are required to be painted red.

All curbs and signs are to be maintained by the property owner.

All signs must conform to Menlo Park Fire Protection District Standards

(See Drawing No. 4)

FIRE LANE STRIPING

All designated fire lanes without curbs shall be striped in accordance with the details listed below in drawings No. 1 and No 2.

- Striping shall be continuous 8" in width, and red in color
- Striping is to be painted on the outer edge of the fire lane
- Fire lanes must be maintained and designated a minimum of twenty (20) feet in width, unless approved by the Fire Chief
- Fire lane signs shall be approved by Menlo Park Fire Protection District standards

(See Drawings No. 1 and No. 2)

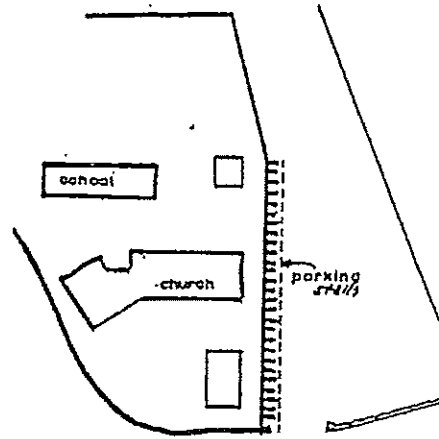
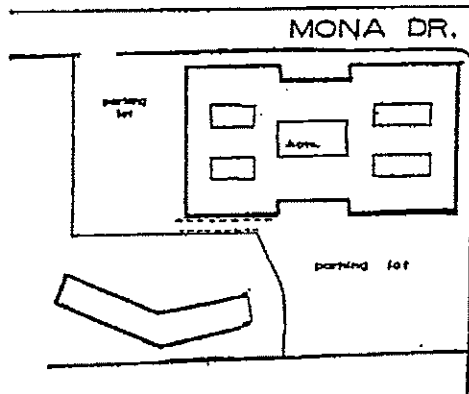

RED CURB

Required on all curbs adjacent to fire lanes, access roads, or other posted "fire lanes" when entrance sign is used.

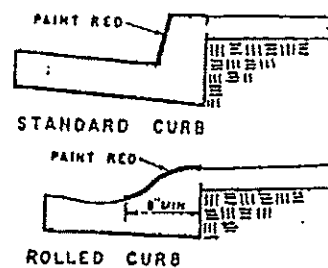

FIRE LANE SIGN POST INSTALLATION

This Standard defines the Menlo Park Fire Protection District minimum requirements for the installation of fire lane signpost installations.

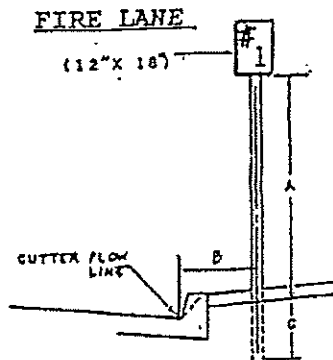

POST INSTALLATION – Sign #1

- A = 7' in sidewalk or pedestrian areas
5' in all other areas
- B = 18" with standard curb
24" with rolled curb to center of post
- C = 24" minimum embedment

NOTE: Signs may be mounted on existing posts or buildings, if post or building is no more than 24" from curb or edge of road surface.

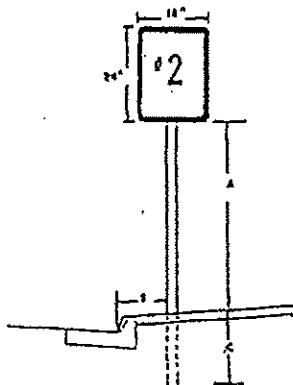

SIGN AND POST INSTALLATION – sign #2

- A = 7' in sidewalk or pedestrian area
3' in all other areas
- B = 18" standard curb
24" rolled curb
- C = 24" minimum embedment

NOTE: Signs may be mounted on entrance gates, buildings, or existing posts if the above are within 24" of the curb or edge of road surface.

**MENLO PARK FIRE PROTECTION DISTRICT
APPROVED FIRE LANE SIGNS**

The following signs are approved by the Menlo Park Fire Protection District for fire lanes and access roads on private commercial and industrial properties:

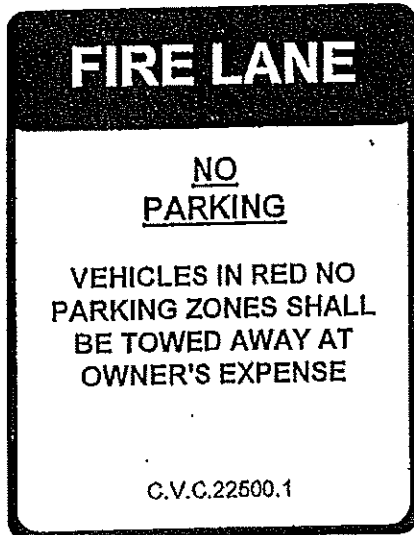

FIRE LANE SIGN "A"

12" X 18"
Red Letters on White
Not Reflectorized
.063 Gauge



ENTRANCE SIGN "B"

18" X 24"
Red Letters on White
Not Reflectorized
.80 Gauge

NOTE: All information on signs must appear as shown.

Drawing No. 1

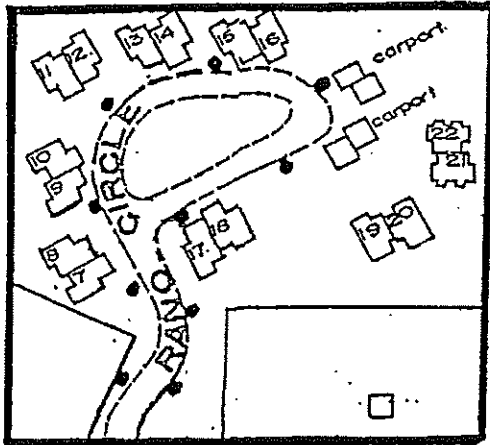

• = Post with sign "A"

Drawing No. 2

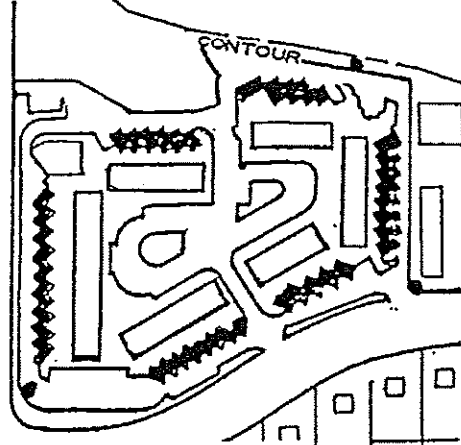

• = Post with sign "B"
 - = Red Curbs

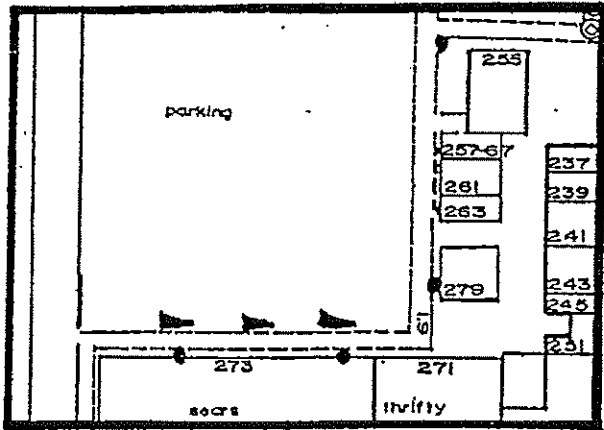

Drawing No. 3

• = Post with sign "A"
 — = Island

Drawing No. 4

• = Post with sign "B"

